

PLACA 30 X 12 COM LETRA EM RELEVO E BRAILE - COM UMA LINHA E NUMERAÇÃO DE SALA

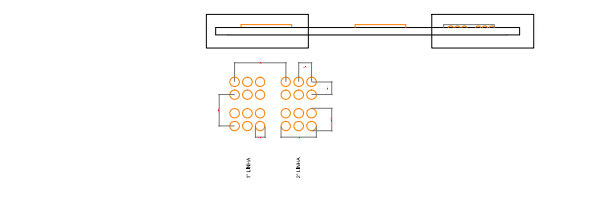

CARRIMBOS E APROVAÇÕES:

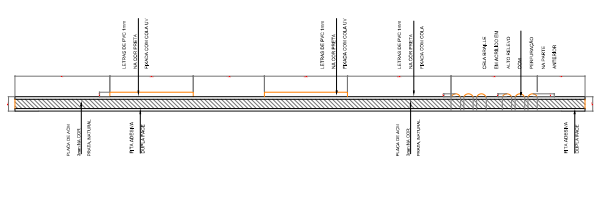
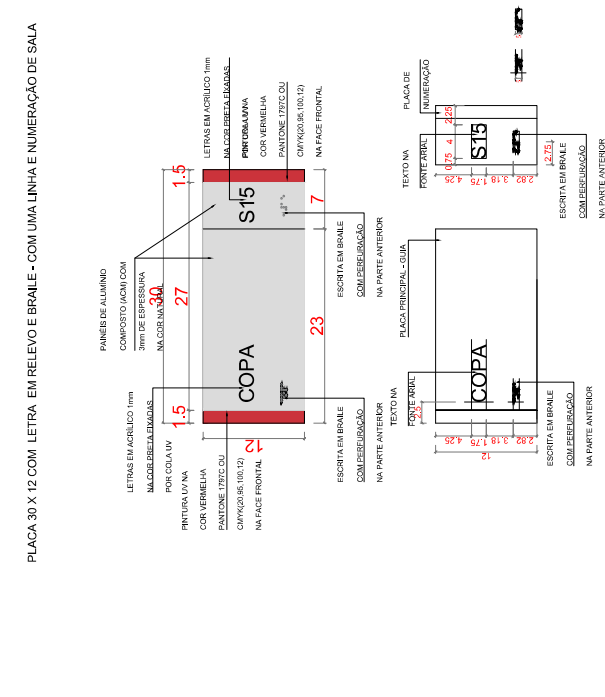
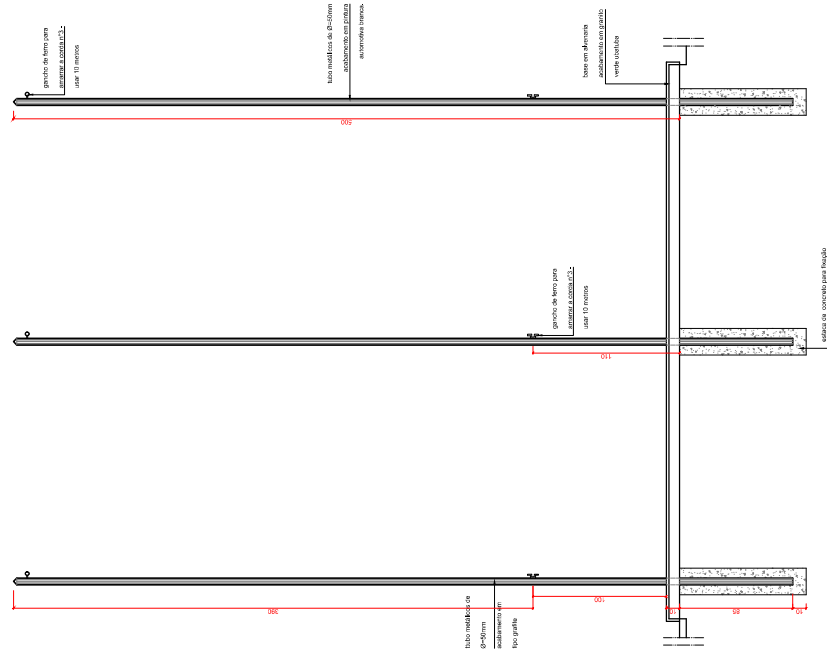
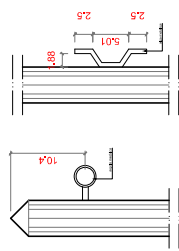
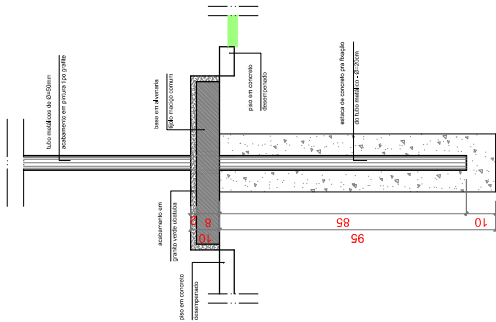

PODER LEGISLATIVO DE MONTES CLAROS DE GOIÁS  
 P.L. Nº 001/2022 - COMISSÃO DE RECURSOS DE MONTES CLAROS DE GOIÁS - GO  
 QUADRA 05, LOTES 797A E 80, SETOR CENTRAL - MONTES CLAROS DE GOIÁS - GO

PROPRIETÁRIO: CÂMARA MUNICIPAL DE MONTES CLAROS DE GOIÁS - CNPJ Nº 08.212.173/0001-51

AUTOR DO PROJETO: ARQUITETO E URBANISTA - RUIPE DA SILVA MACIELMESES - GOIÁ 10189438

CONTEÚDO:	PLANTA DA SALA	ESCALA:	1:1
PLANTA DE ABERTURA	QUADROS DE ABERTURA	DATA:	05/2022
PERFIL DO TERRENO	PERFIL DO TERRENO	DESENHADO:	RUIPE
REVISÃO:		FEITO:	

ARQUITETURA

ÁREAS:	ÁREA DO TERRENO = 67,00m <sup>2</sup> ÁREA CONSTRUIDA = 440,00m <sup>2</sup> ÁREA TERRENO ÚTIL = 15,25m <sup>2</sup>
FECHA:	ARQ11/21



PLANO DE DISTRIBUIÇÃO DE ÁGUA



**NOTAS E CONVENÇÕES**  
 \* Todo o piso superior pode ser Elevado, porcolinado cimentado  
 \* Utilizar acabamento recomendado pelo fabricante  
 \* Assentem com argamassa AC118, aplicando no piso e no porcelanado

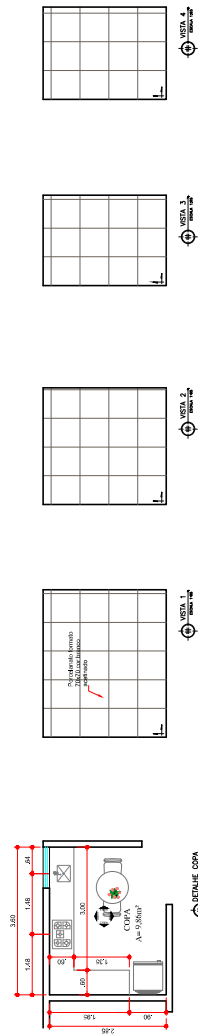

DETALHE COZINHA

VISTA 1

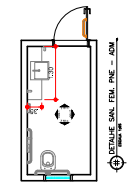

DETALHE SAN. TEL. PNE - ADM.

VISTA 2

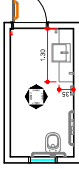

DETALHE SAN. MASC. PNE - ADM.

VISTA 3

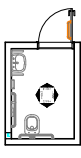

DETALHE SAN. MASC. PNE - AID.

VISTA 4

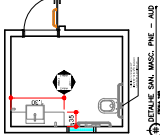

DETALHE SAN. MASC. PNE - AID.

VISTA 5

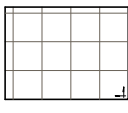

VISTA 1

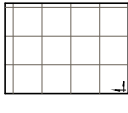

VISTA 2

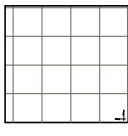

VISTA 3

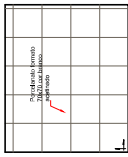

VISTA 4

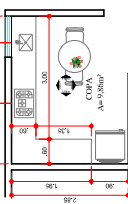

VISTA 5

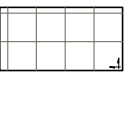

VISTA 6

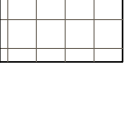

VISTA 7

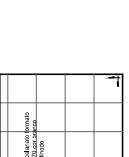

VISTA 8

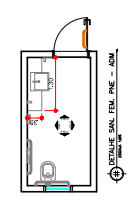

VISTA 9

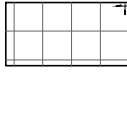

VISTA 10

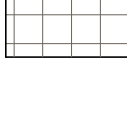

VISTA 11

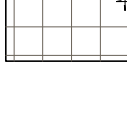

VISTA 12

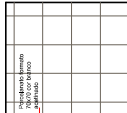

VISTA 13

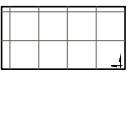

VISTA 14

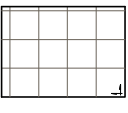

VISTA 15

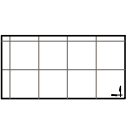

VISTA 16

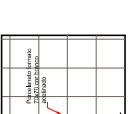

VISTA 17

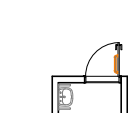

VISTA 18

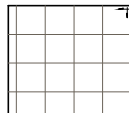

VISTA 19

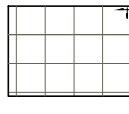

VISTA 20

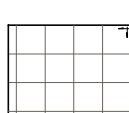

VISTA 21

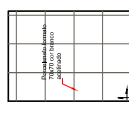

VISTA 22

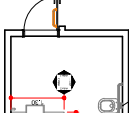

VISTA 23



PODER LEGISLATIVO DE MONTES CLAROS DE GOIÁS  
 P.O. Nº 001/2022 - COMISSÃO DE RECURSOS  
 QUADRA 05, LOTES 794 E 80, SETOR CENTRAL - MONTES CLAROS DE GOIÁS - GO

PROPRIETÁRIO: CÂMARA MUNICIPAL DE MONTES CLAROS DE GOIÁS - CNPJ: 08.012.770/0001-51  
 AUTOR DO PROJETO: ARQUITETO E URBANISTA - RUIPE DA SILVA VAMACINER - CREA: 0189804  
 R. T. DA OBRAS:

# ARQUITETURA

CONTÍDIO: PAINEL DO DE PISO PROVAÇÃO DE REVESTIMENTOS	ESCALA:	INDICADAS
	DATA:	09/2022
	DESENHO:	RUIPE

ÁREAS: ÁREA DO TERRENO = 670,00m² ÁREA CONSTRUIDA = 440,00m² ÁREA PERMITEIDA = 670,00m² = 100%	FORMA ARQ12/21
---	-------------------

CARIMBOS E APROVAÇÕES:

J1

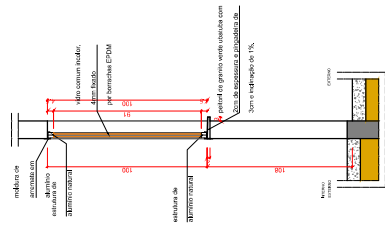
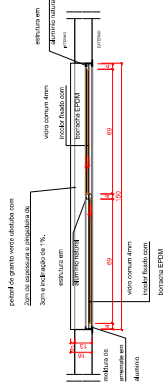
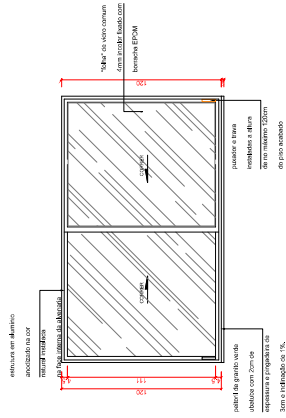

J1 - 100x100cm  
Cordeiro interno, janela, funcionamento básico, secarista  
- perfil corre 2, vidro (2 vidros) colado na face interna de 22  
e vidro fixo no vidro 4mm fixado com borna EPDM. Puxador e  
borna medidos instalados à altura de 115cm do piso acabado.

J2

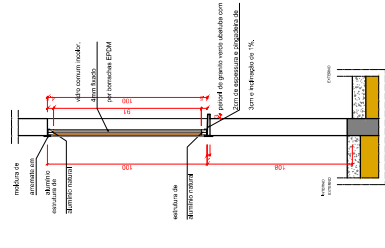
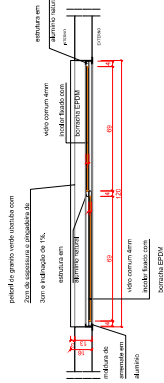
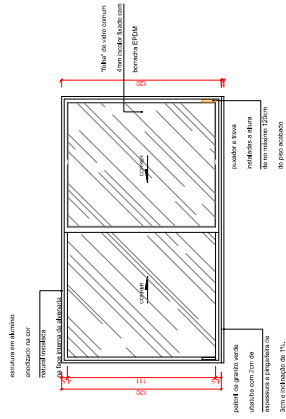

J2 - 100x100cm  
Cordeiro interno, janela, funcionamento básico, secarista  
- perfil corre 2, vidro (2 vidros) colado na face interna de 22  
e vidro fixo no vidro 4mm fixado com borna EPDM. Puxador e  
borna medidos instalados à altura de 115cm do piso acabado.

J3

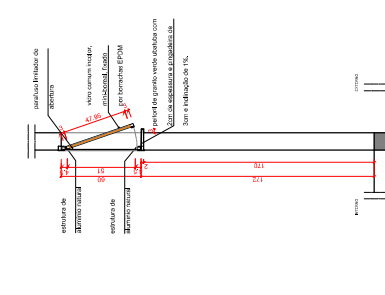
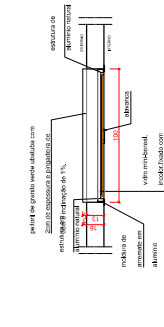
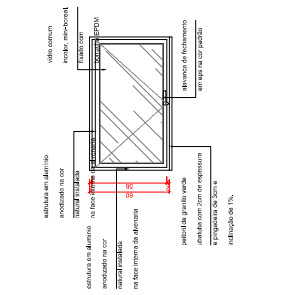

J3 - 100x100cm  
Cordeiro interno, janela, funcionamento básico, secarista  
- perfil corre 2, vidro (2 vidros) colado na face interna de 22  
e vidro fixo no vidro 4mm fixado com borna EPDM. Puxador e  
borna medidos instalados à altura de 115cm do piso acabado.

CARIMBOS E APROVAÇÕES:



PODER LEGISLATIVO DE MONTES CLAROS DE GOIÁS  
R. L. DA OIRA, 100 - JARDIM CLAROS - MONTES CLAROS DE GOIÁS - GO  
QUADRA 05, LOTES 794 E 80, SETOR CENTRAL - MONTES CLAROS DE GOIÁS - GO

PROPRIETÁRIO: CÂMARA MUNICIPAL DE MONTES CLAROS DE GOIÁS - CNPJ: 08.012.170/0001-51

AUTOR DO PROJETO: ARQUITETO E URBANISTA - RUIPE DA SILVA VAGACHES - CREA 018864

R. L. DA OIRA

# ARQUITETURA

CONTEÚDO: DETA L HES DE JANELAS	ESCALA:	INDICAÇÕES:
	DATA:	09/2022
	DESENHO:	RUIPE

ÁREAS: ÁREA DO TERRENO = 670,00m² ÁREA CONSTRUIDA = 440,00m² ÁREA PERMITEIDA = 670,00m² = 100%	FORMA ARQ13/21
---	-------------------

J6

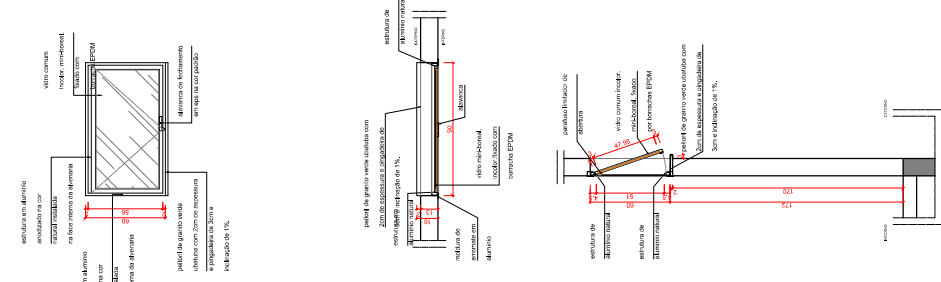

36 - 100x100mm  
 Alumínio  
 Janela com 2 vidros (2 vidros) montada na base interna da janela e vidro isolante em borname EPDM. Parafusos e travas metálicas instaladas a 15cm do piso acabado.

J5

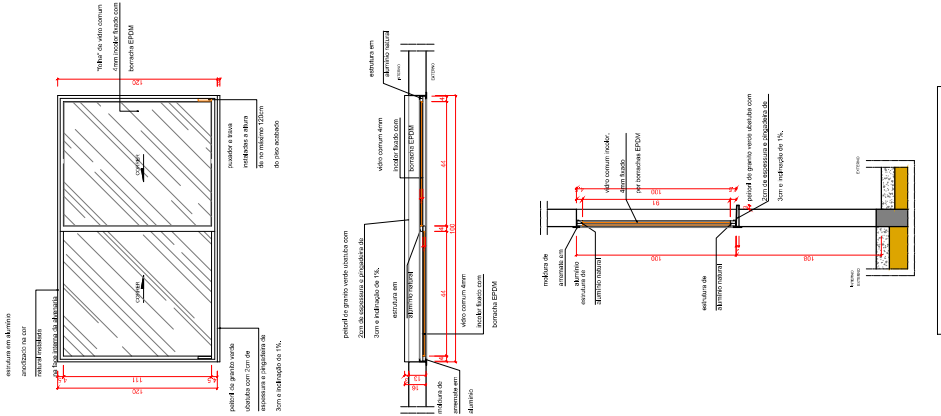

35 - 100x100mm  
 Alumínio  
 Janela com 2 vidros (2 vidros) montada na base interna da janela e vidro isolante em borname EPDM. Parafusos e travas metálicas instaladas a 15cm do piso acabado.

J4

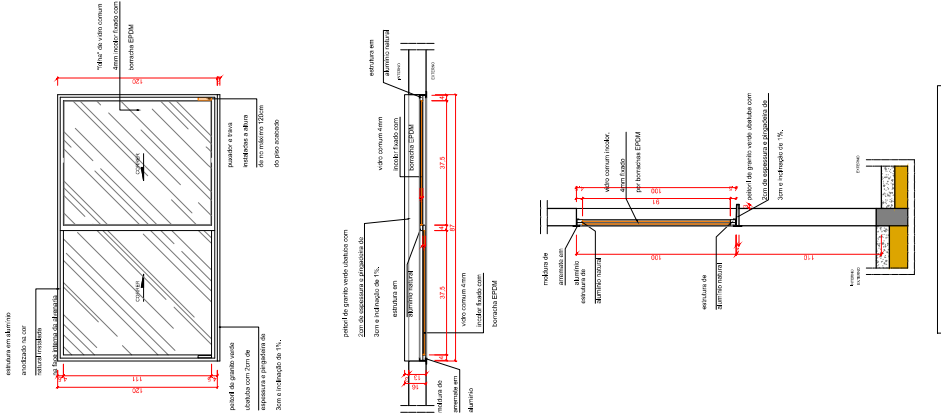

34 - 100x100mm  
 Alumínio  
 Janela com 2 vidros (2 vidros) montada na base interna da janela e vidro isolante em borname EPDM. Parafusos e travas metálicas instaladas a 15cm do piso acabado.



CÂMARA MUNICIPAL DE  
**MONTES CLAROS DE GOIÁS**  
 Transparência e Responsabilidade  
 Gestão 2022

PODER LEGISLATIVO DE MONTES CLAROS DE GOIÁS  
 P.C. - PARECER Nº 012/2022 - COMISSÃO DE RECURSOS  
 QUADRA Nº. LOTES 794 E 80, SETOR CENTRAL - MONTES CLAROS DE GOIÁS - GO

PROPRIETÁRIO: CÂMARA MUNICIPAL DE MONTES CLAROS DE GOIÁS - CNPJ: 08.012.173/0001-31  
 AUTOR DO PROJETO: ARQUITETO E URBANISTA - RUIPE DA SILVA VAGANHAES - GOUAT018@GMAIL.COM

CONTÍDUO: DETALHES DE JANELAS	ESCALA: INDICADAS
DATA: 09/2022	DESENHO: RUIPE

ARQUITETURA

FORMA  
 ARQ14/21

ÁREA DO TERRENO = 670,00m²  
 ÁREA CONSTRUIDA = 440,00m²  
 COEFICIENTE DE OBRUSÃO = 65,22%

CARIMBOS E APROVAÇÕES:

# J7

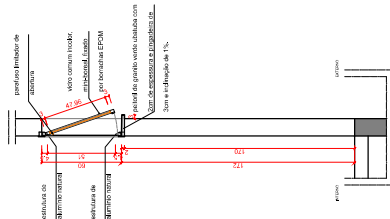
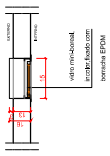
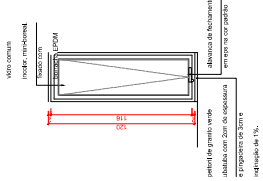

J7 - 100x100cm  
sentido para o lado externo  
Janela com vidro comum, isolante insonorizante, abobada com zona de espessura e propagação de fumaça de 20mm, 1% de inclinação.

# J8

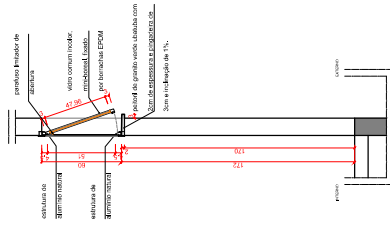
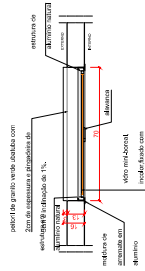
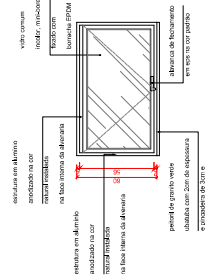

J8 - 100x100cm  
sentido para o lado externo  
Janela com vidro comum, isolante insonorizante, abobada com zona de espessura e propagação de fumaça de 20mm, 1% de inclinação.

# J9

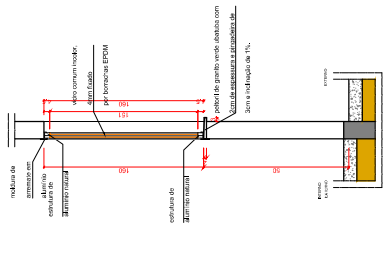
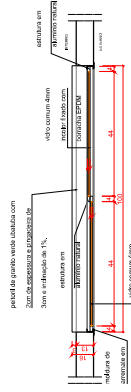
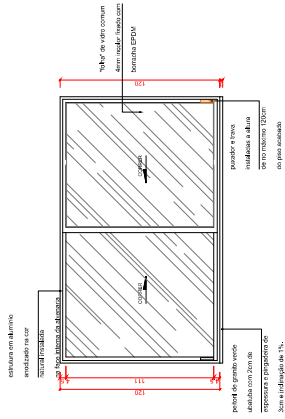

J9 - 100x100cm  
sentido para o lado externo  
Janela com 2 vidros 2,5mm (com vidro espessura) no lado interno do painel com espessura e propagação de fumaça de 20mm, 1% de inclinação.



CÂMARA MUNICIPAL DE MONTES CLAROS DE GOIÁS  
Transparência e Responsabilidade  
Gestão 2022

PROPRIETÁRIO: CÂMARA MUNICIPAL DE MONTES CLAROS DE GOIÁS - CNPJ: 06.012.770/0001-31  
AUTOR DO PROJETO: ARQUITETO E URBANISTA - RUIPE DA SILVA VAUGHANES - GOUATI@RUIPE.COM.BR

## ARQUITETURA

CONTEÚDO: DETALHES DE JANELAS  
DATA: 09/2022  
INDICADAS  
DESENHO: RUIPE  
RUA DA OBRAS

ESCALA: INDICADAS  
RUIPE  
FOLHA: ARQ15/21  
FORMA: ARSADO TERRENO - 670,00m²  
ÁREA CONSTRUIDA - 440,00m²  
ÁREA PERMEÁVEL - 67,00m² - 10,00%

CARIMBOS E APROVAÇÕES: